

2019/9/7 Hokkaido
Snooker
T.Watanabe

-10

-5

0

5

10

15

25

20

15

10

5

25

20

15

10

5

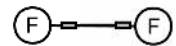
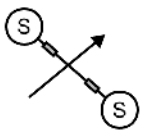
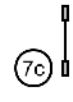
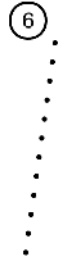
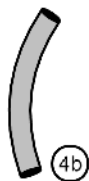
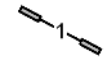
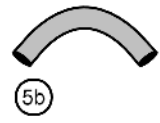
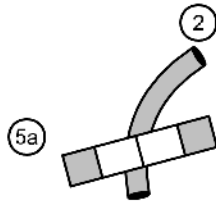

PMini/PMidi/25cm/35cm/40cm-54sec.
PS/PL/50cm/55cm/60cm-50sec

3 or 4 Reds. Combos can be taken in any order. Start&Finish jumps live at all time.
Closing as numbered.

1-2-3-5 Point system. See-saw & A-Frame 3P. D-walk & Weave 5P
 Contact to contact NG. Back to Back OK except contacts.

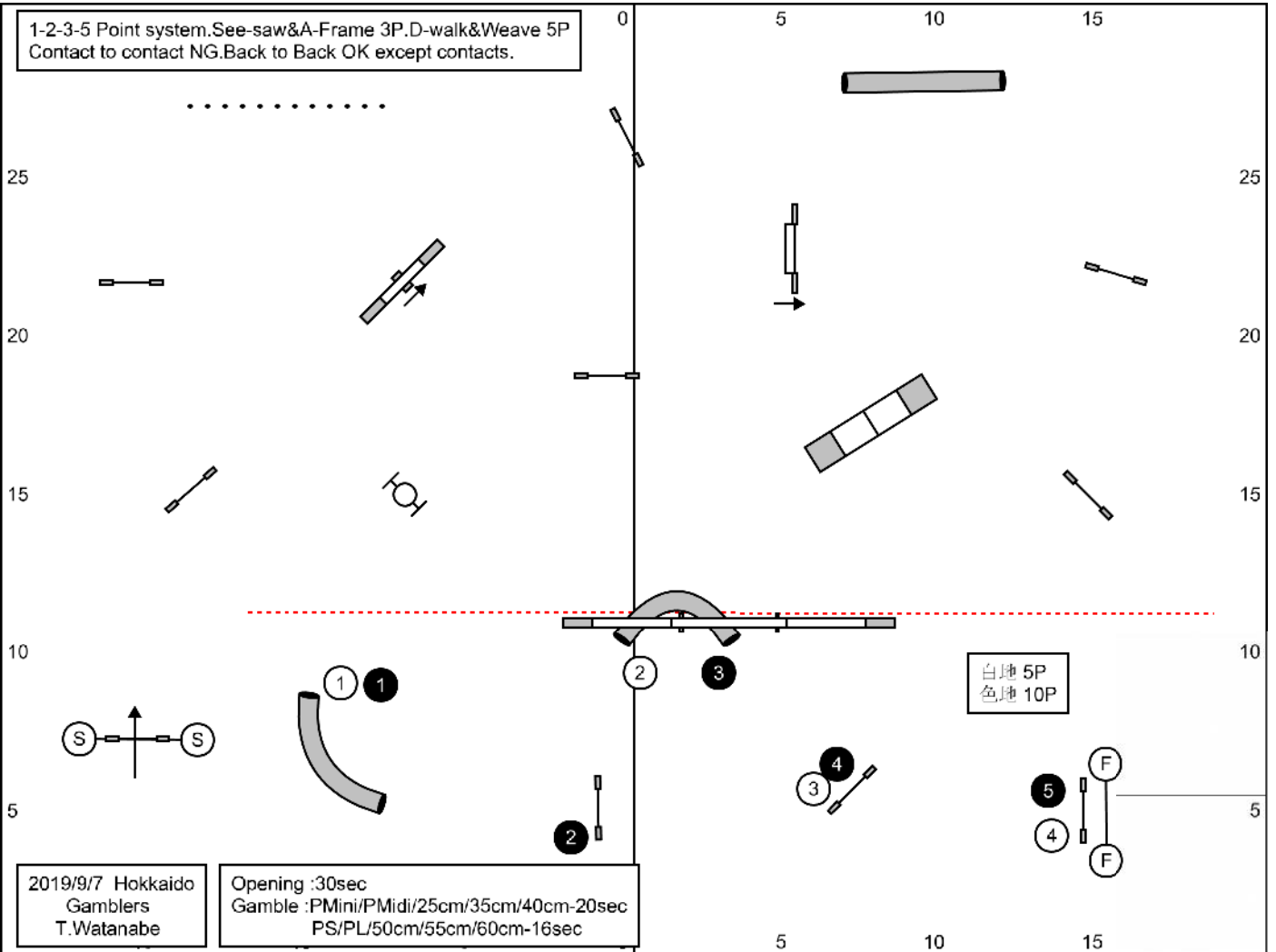

2019/9/7 Hokkaido
 Gamblers
 T. Watanabe

Opening :30sec
 Gamble : PMini/PMidi/25cm/35cm/40cm-20sec
 PS/PL/50cm/55cm/60cm-16sec

白地 5P
 色地 10P